

Geneva

Lake

Plat of Survey

of

A parcel of land described on a Quit Claim Deed recorded in Vol. 142 on Page 672 as Document No. 695967 as follows:

Land located in the North 1/2 of fractional Section 13, Town 1 North, Range 16 East, Village of Fontana-on-Geneva Lake, Walworth County, Wisconsin, described as follows: Commence at the East 1/4 section corner of said Section; thence North 88°-41' West along the East-West 1/4 section line, 1564.73 feet to the point of beginning; thence North 1°-00' East, 390.15 feet; thence North 89°-00' West, 19.89 feet; thence North 1°-00' East, 278.48 feet to a point on meander line, which point is located South 1°-00' West, 42.28 feet more or less from the shore of Geneva Lake; thence North 88°-29'-47" West, along said meander line, 148.25 feet to a point which point is located South 1°-00' West, 42.53 feet more or less from the shore of Geneva Lake; thence South 1°-00' West, 336.61 feet; thence South 89°-00' East, 18.00 feet; thence South 1°-00' West, 337.67 feet to the East-West 1/4 section line; thence South 88°-41' East along the East-West 1/4 section line, 149.87 feet to the point of beginning, also all the land between the above described meander line and the shore of Geneva Lake, total parcel contains 2.46 acres of land more or less.

Surveyed for: **Edward S. Lyon**
986 South Shore Drive
Pontana, Wisconsin. 53125

Tax Parcel
STFV 00093

Top of Concrete
Mon., elev.=898.6

Tax Parcel
STFV 00088A

Tax Parcel
STFV 00094

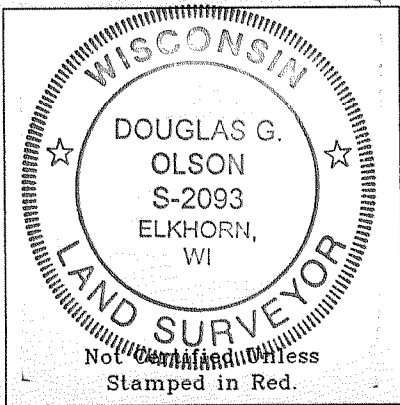
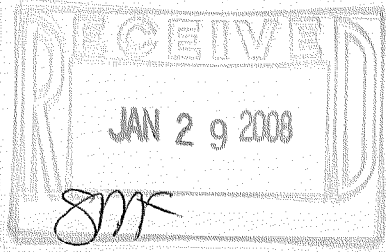
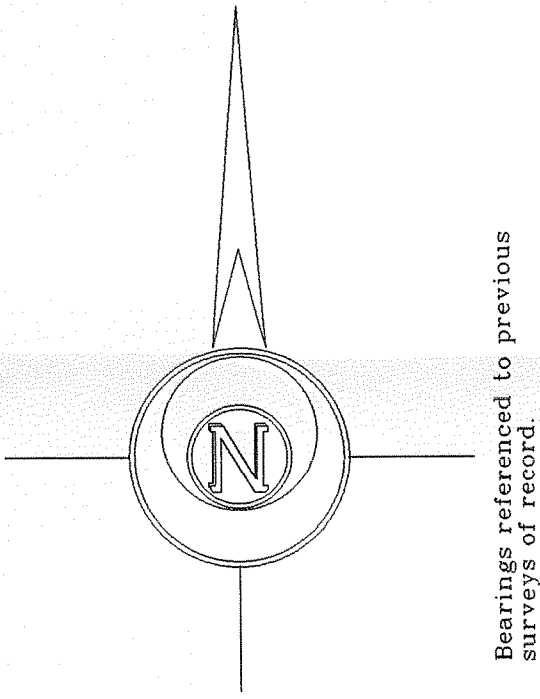

Notes: 1) This survey plat is not certified unless signed and sealed in red ink.
2) This survey is subject to Wisconsin lien laws. This Plat of Survey is the notice of intent to file lien. Lien waiver required.

Copyright © 2007 by Jensen & Olson Land Surveying, LLC.
All rights reserved. No part of this survey plat may be reproduced or transmitted in any form by any means - graphic, electronic, or mechanical, including photocopying, tracing, or information storage and retrieval systems - without permission in writing from Douglas G. Olson, Jensen & Olson Land Surveying, LLC.

I, Douglas G. Olson, Wisconsin Registered Land Surveyor, do hereby certify that this survey was performed by me or under my direction in full compliance with the owner's/agent's instructions and Chapter A-E 7 of the Wisconsin Administrative Code "Minimum Standards for Property Surveys" and that this map is an accurate representation thereof to the best of my knowledge and belief.

Douglas G. Olson
Wisconsin Registered Land Surveyor - 2093

Sheet 1 of 1 Sheets.

Legend

- Found County Section Corner
- Found Concrete Monument
- Found Iron Pipe
- Found Iron Rod
- Set Iron Rod, 3/4" diameter
- Recorded Information
- Utility Pole
- Asphalt Surface
- Gravel Surface
- Block Walk



Jensen & Olson Land Surveying, LLC

45 South Wisconsin Street P.O. Box 322
Elkhorn, Wisconsin. 53121
Telephone: (262) 723-3434
Facsimile: (262) 723-8044

Scale in Feet

1" = 30'



Survey date: Plat of Survey - July 13, 2000.

Revisions: North 1/2 Topo - November 7, 2002
South 1/2 Topo - December 15, 2006

2006.144

Job Reference Number
2006.144

139710e-2006144-2006144total(1e)30scale.290

STFV-88

005-2549